

Features

- Compliance to Lighting and LED Equipment Regulations
- IP20 for Indoor Installation
- MM Marking for Furniture Installation
- Suitable for LED Lighting Applications
- 1 Year Warranty

Marks / Approvals



Image similar, variations possible

Specifications

MODEL No.	PART No.	Voltage	Min. Load	Max. Load	Max. Power	Ripple Voltage (mV)
SS150-12VL	SS150-12VL	12 V	0.00 A	11.0 A	132 W	3 %
SS150-24VL	SS150-24VL	24 V	0.00 A	6.25 A	150 W	3 %
SS150-48VL	SS150-48VL	48 V	0.00 A	3.125 A	150 W	3 %
INPUT	Voltage	AC 200 V – 240 V				
	Frequency	50 Hz - 60 Hz				
	Current (rms max)	< 0.9 A				
	Power Factor	≥ 0.95				
PROTECTION	Overload	Hiccup mode, restart automatically after fault correction				
	Overvoltage	NA				
	Short Circuit	Hiccup mode, restart automatically after fault correction				
	Over Temperature	NA				
	Input Surge Current	< 70 A				
OTHERS	Cooling	Convection Cooling				
	Average Efficiency	> 89 % typical				
	Startup Time	< 0.5 s				
	Protection Marking	IP20 (IEC 60529)				
	Working Noise	< 35 dB, pickup at 10 cm				
	Protection Class	Class II				
Environment	Case Material	Plastic cover with terminal block H03VVH2-F 2x0.75mm ²				
	Temperature	Operating: -20 °C to 45 °C / Max. Case Temperature (Tc): 90 °C				
	Humidity	Operating: 5 % RH to 85 % RH				
Nominal Lifetime	50 000 hrs at max. Ta, rated input voltage, output max. rated power					
SAFETY	EN61347-1; EN61347-2-13; EN62493; AS/NZS 61347.2.13; EN61347-2-13; EN61347-1					
EMI	EN 55015					
EMS	EN 61547					
Harmonic	EN 61000-3-2 Class C					

Specifications subject to change without notice

Case Dimensions

179.4 mm × 62.5 mm × 30.6 mm

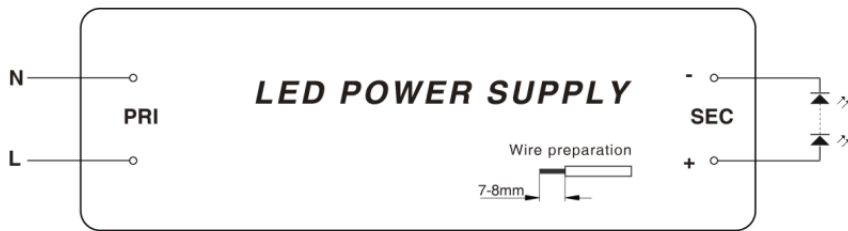
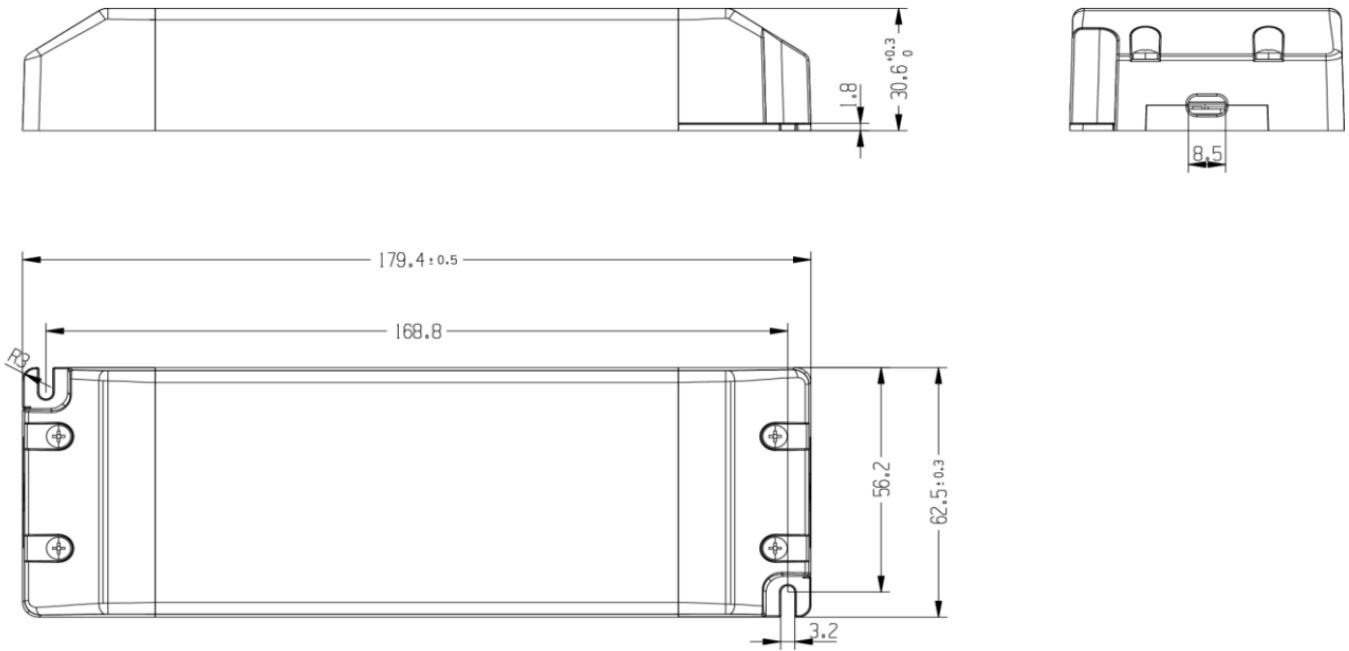

AC	Terminal+ H03VVH2-F 2×0.75mm ²
DC	Terminal+ H05VVH2-F 2×1.0mm ²