

Features

- Adjustable Output Voltage
- LED Operation Indicator
- EN 43880 Installation Standard 2SU
- No-Load Consumption < 0.3W
- High Efficiency / High Reliability
- Convection Cooled
- 1 Year Warranty



Marks / Approvals



Specifications

Product similar to photo, variations possible

MODEL	Output Voltage	Voltage Adjustment	Min. Load	Rated / Max. Load	Ripple & Noise	Line / Load Reg.	Efficiency	O.V.P.	Max. Power
DLP 1030D-05S	5 V	±10 %	0 A	6.00 A (8.0 A for 3 s)	50 mV p-p	±1 %	78 % Ref.	7.13 ~ 7.88 V	30 W
DLP 1050D-12S	12 V	±10 %	0 A	4.20 A	120 mV p-p	±1 %	85 % Ref.	17.1 ~ 18.9 V	50 W
DLP 1050D-24S	24 V	±10 %	0 A	2.10 A	240 mV p-p	±1 %	86 % Ref.	31.4 ~ 34.7 V	50 W
DLP 1050D-48S	48 V	±10 %	0 A	1.04 A	480 mV p-p	±1 %	86 % Ref.	64.6 ~ 71.4 V	50 W
INPUT	Voltage Range		90~264 VAC / 127~380 VDC						
	Frequency		47~63 Hz						
	Inrush Current (25 °C)		40 A (110 VAC) / 80 A (220 VAC)						
OUTPUT	Hold-up Time		13 ms						
	Short Circuit Protection		Autorecovery						
	Over Load Protection		Automatic Power Limited						
OTHERS	Cooling		Convection						
	Efficiency		Compliance To 80Plus Criterion / ErP Regulation						
ENVIRONMENT	Temperature		Operating: -15 °C – 50 °C Ambient / Storage: -20 °C – 85 °C Ambient						
	Humidity		20 % RH – 90 % RH Non Condensing						
	Vibration		2G, 10 ~ 500 Hz, 3 axes						

CE Standards EN 55032, EN 55024; EN 61000-3-2, -3 (EN 61000-4-2, -3, -4, -5, -6, -8, -11); LVD: EN 62368-1

NOTES:

- Each output can provide up to maximum load, but total load can not exceed rated output power.
- Line regulation is measured from low line to high line at rated load.
- Load regulation is measured from 20% to 100% of rated load at 220VAC input.
- Ripple & Noise are measured with 20MHz oscilloscope at 220VAC by using a 20cm long 12" twisted pair-wire with a 0.1uF/630V metal capacitor & a 47uF electrolytic capacitor parallel on the test point.
- Efficiency is measured at rated load and 220VAC input.
- Hold-up time is measured at rated load and 220VAC input.
- Output Voltage Adjustable is measured on 5% of rated load.

Specifications subject to change without notice

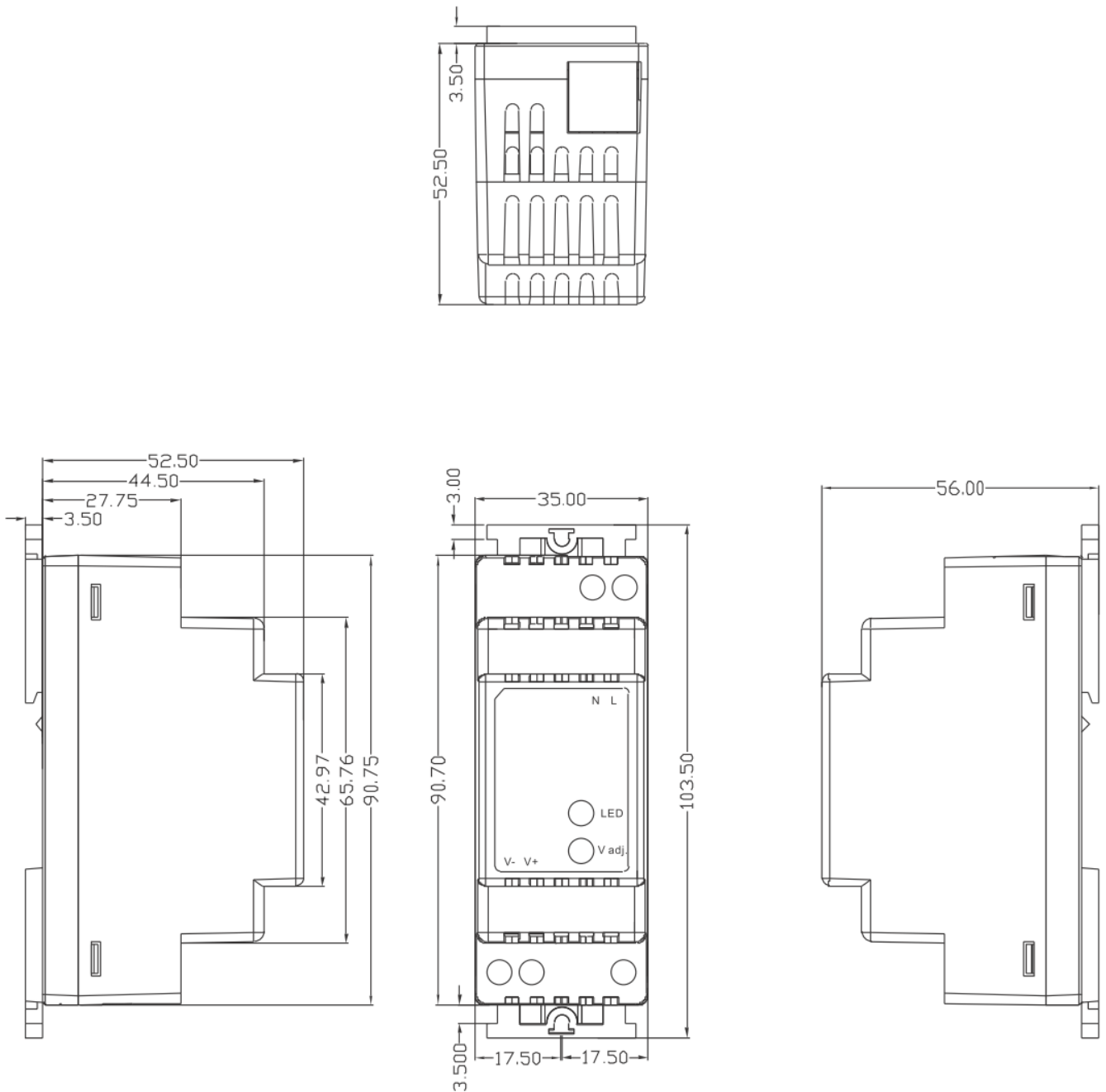

CASE NO. : CS025D

UNIT : mm

DIMENSION : 52.5(H)*90.7(D)*35(W)

MATERIAL : PLASTIC

COLOR : BLACK

Single	Description
N	Neutral Terminal Of AC Input (No Polarity At DC Input)
L	Line Terminal Of AC Input (No Polarity At DC Input)
V-	DC Negative Output Terminal
V+	DC Positive Output Terminal
LED	Green LED Indicator
V adj.	Potentiometer For Output Voltage